

FORM No. 1.

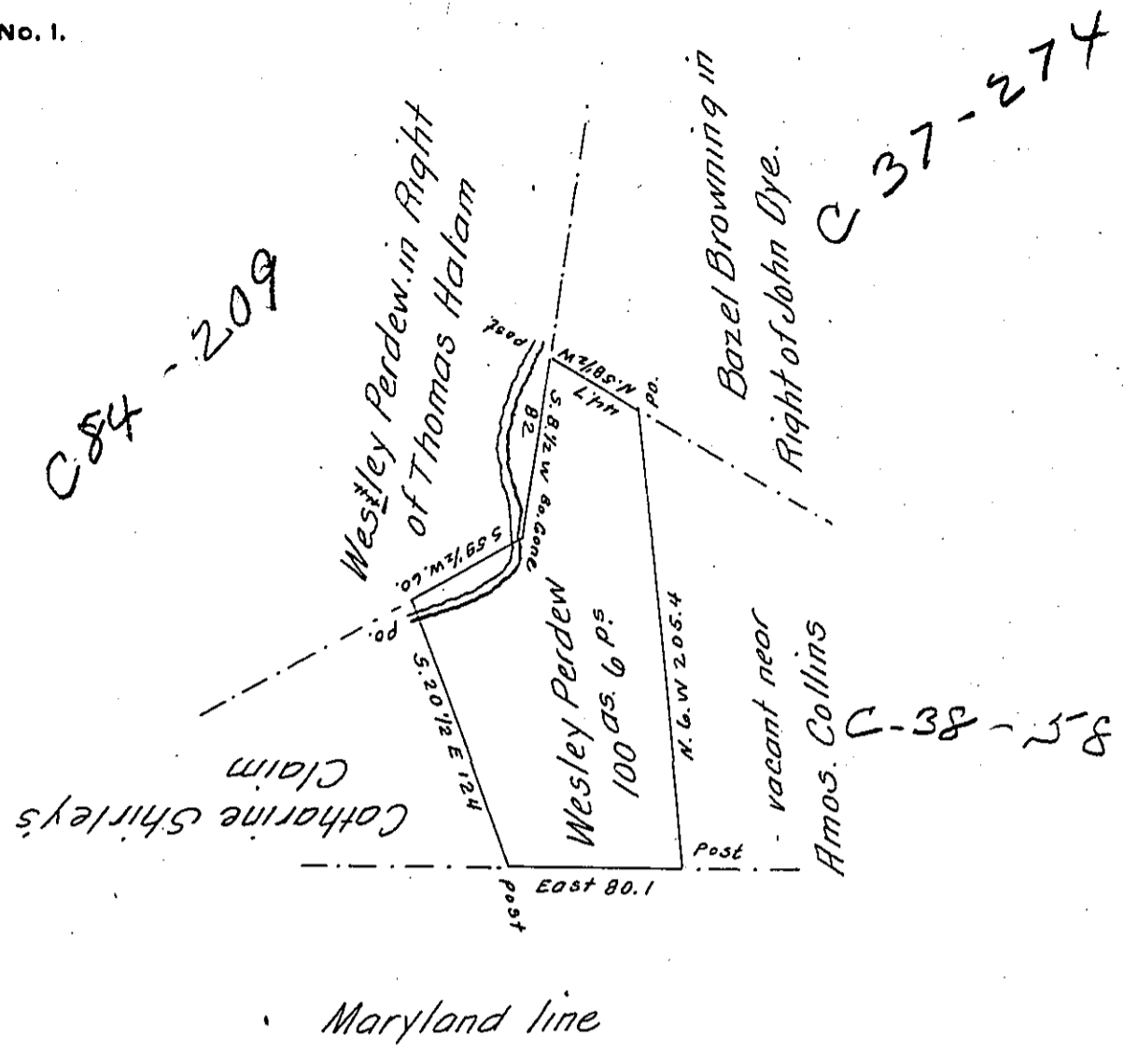

Situate in Southampton Township Bedford County. Containing 100 Acres. 6 Perches. And the usual allowance of Six Per Cent. for Roads &c. Surveyed 2^d day of Oct. 1855. Reexamined the 27th day of Oct. 1858. In Pursuance of a Warrant granted to Wesley Perdeu. dated the 14th day of Nov. 1856. True bearings

To John Rowe Esqr. }
S.G.

Sam. Metterman C.S.

IN TESTIMONY that the above is a copy of the original remaining on file in the Department of Internal Affairs of Pennsylvania, made conformably to an Act of Assembly approved the 16th day of February, 1833, I have hereunto set my Hand and caused the Seal of said Department to be affixed at Harrisburg, this twenty seventh day of June 1906.

Goac R. Perry
Secretary of Internal Affairs.